

# AKM / AK

## KORDON MAKİNELERİ BORDERING MACHINES

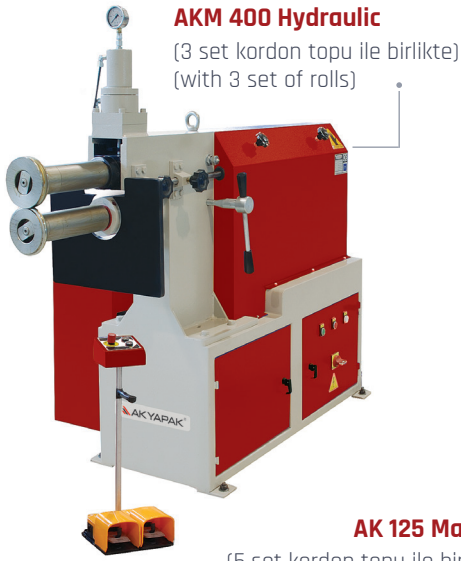

- Özel çelik ve sertleştirilmiş kordon vals topları
- Special grade of material and hardened rolls

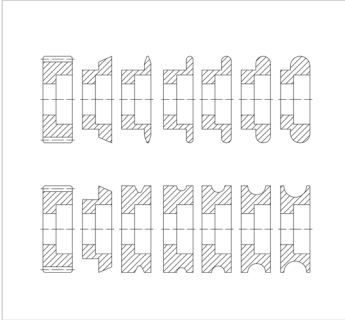

**AK 80 Standart vals topları**  
AK 80 standard rolls

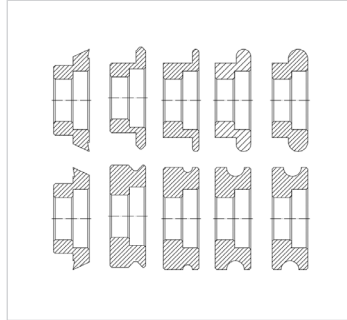

**AK 125 Standart vals topları**  
AK 125 standard rolls

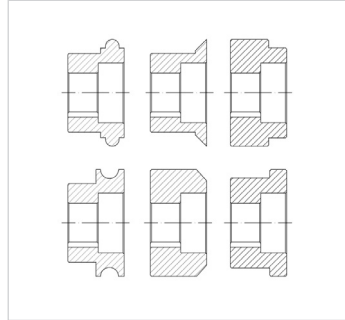

**AKM 250 Standart vals topları**  
AKM 250 standard rolls

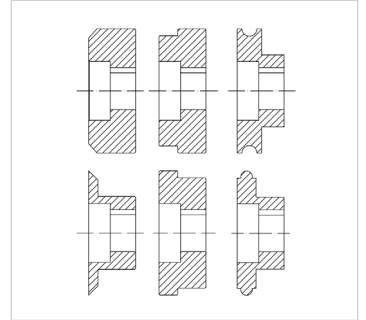

**AKM 400 Standart vals topları**  
AKM 400 standard rolls

### TEKNİK BİLGİLER / TECHNICAL INFORMATION

S.N.	Tip Type	Sac Kalınlığı (mm) Thickness (mm)	Millerin eksen aralığı (mm) Shafts axes distance (mm)	Mil-Gövde aralığı (mm) Roll-body distance (mm)	Motor Gücü (kW) Motor power (kW)	Mil çapı (mm) Shaft diameter (mm)	Dönüş çizgisel hızı (m/dk) Rotation linear speed (m/min)	Boğaz derinliği (mm) Throat depth (mm)	Uzunluk (mm) Length (mm)	Yükseklik (mm) Height (mm)	Genişlik (mm) Width (mm)	Ağırlık (mm) Weight (mm)
1	AK 80	0.80	53	200	-	19	-	220	300	500	200	35
2	AK 125	1.25	62	250	-	26	-	260	600	550	350	50
3	AKM 125	1.25	62	250	0.7	26	6.3	260	1020	1500	600	170
4	AKM 250	2.5	92	260	1.5	35	3.5	500	1200	1200	700	295
5	AKM 400	4.0	132	260	2.2	40	5	500	1650	1280	700	350
6	AKM 250 H	2.5	92	260	1.5+0.55	35	3.5	500	1200	1200	700	320
7	AKM 400 H	4.0	132	260	2.2+0.55	40	5	500	1800	1600	700	450

Yukarıda belirtilen değerler 240 N/mm<sup>2</sup> akma sınırı olan çeliğe göre. Haber vermeksizin değiştirme hakkı saklıdır.  
Data based upon steel 240 N/mm<sup>2</sup> yield point. / All specifications are subject to change without notice.